

AYUNTAMIENTO DE ALCALA DE RENA
20 MAR. 2012



AYUNTAMIENTO DE ALCALÁ DE GENTIL
20 MAR. 2012
JUNTA DE GOBIERNO LOCAL





UE: 2B Av. Madrid Pk. 28.5

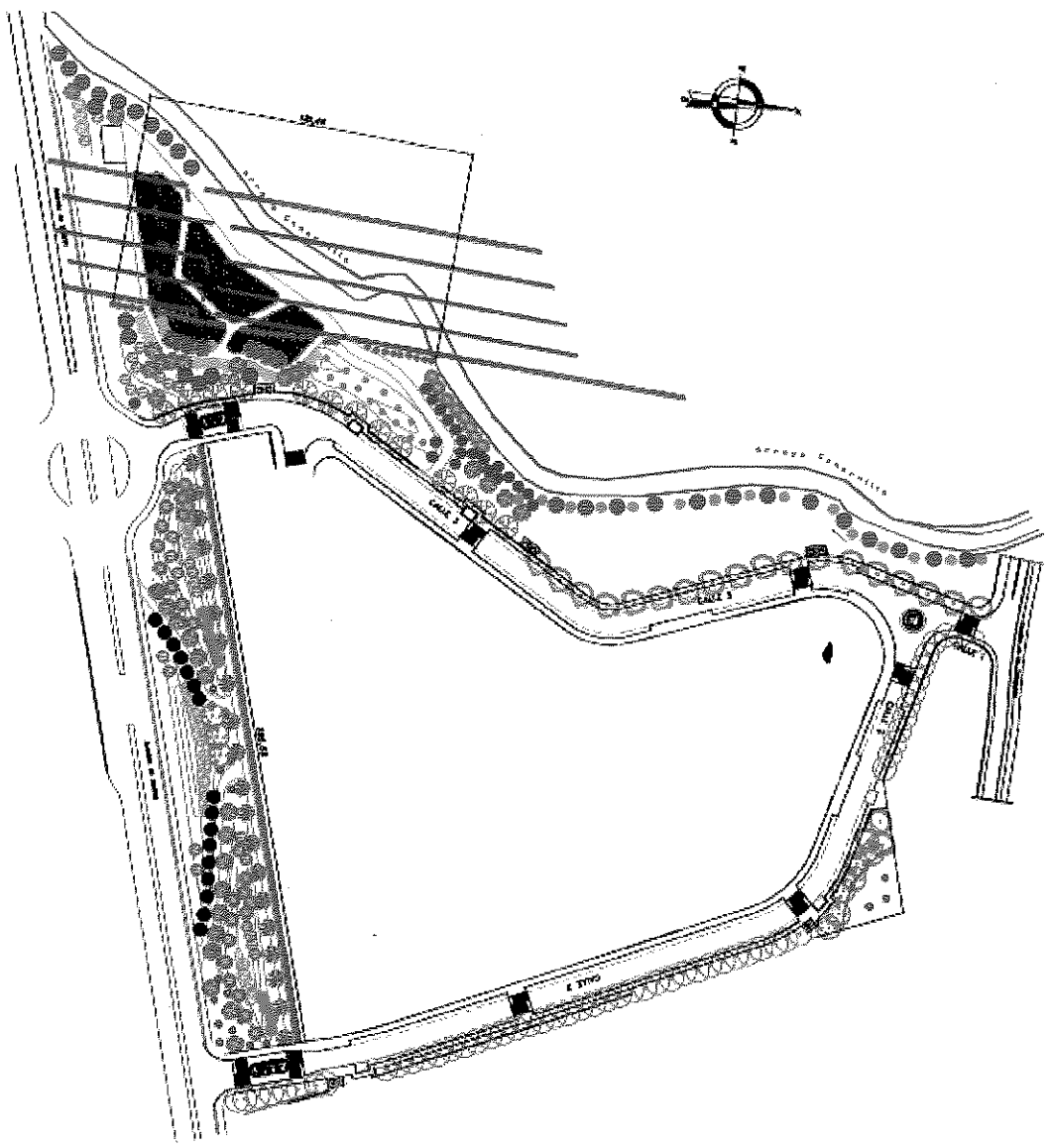

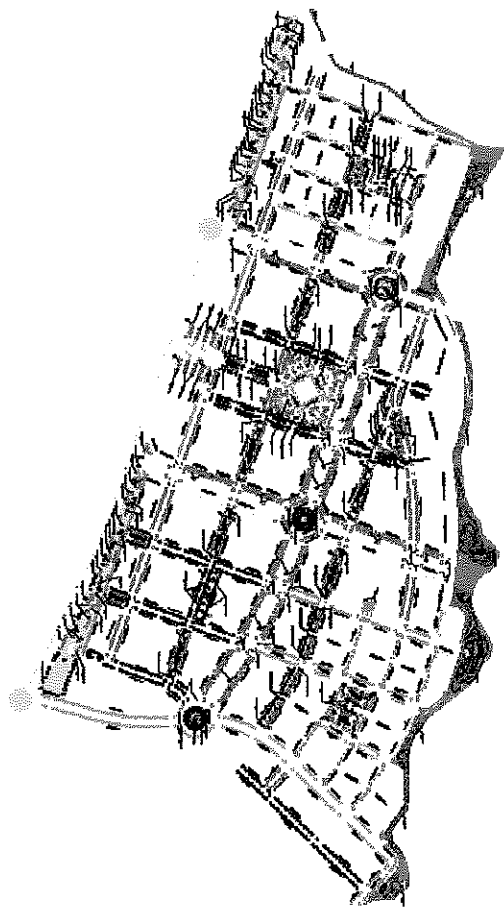
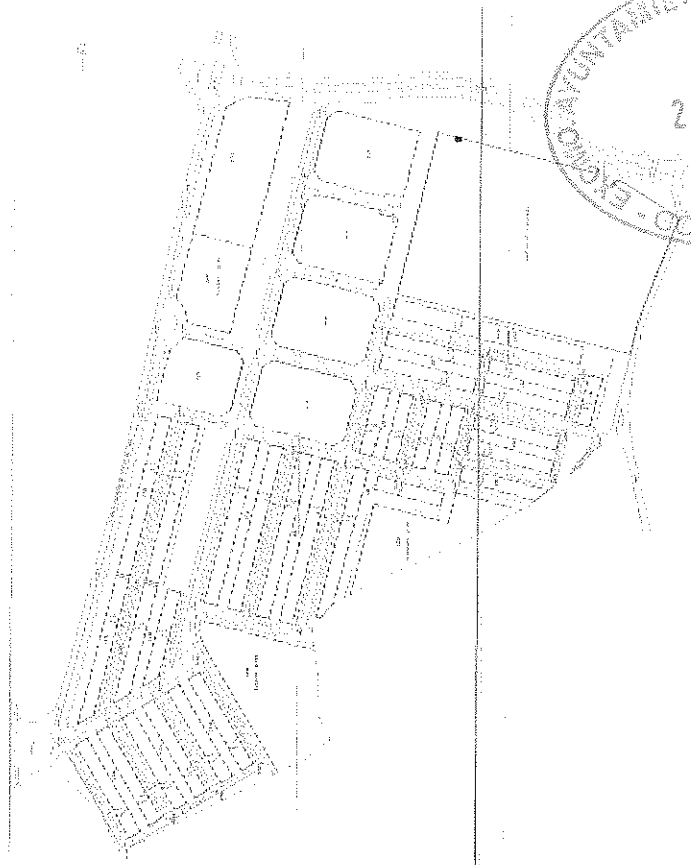

EXCMO. AYUNTAMIENTO DE ALCALA DE SALAMANCA
20 MAR. 2012
JUNTA DE GOBIERNO LOCAL

UE 2A Puerta de Madrid

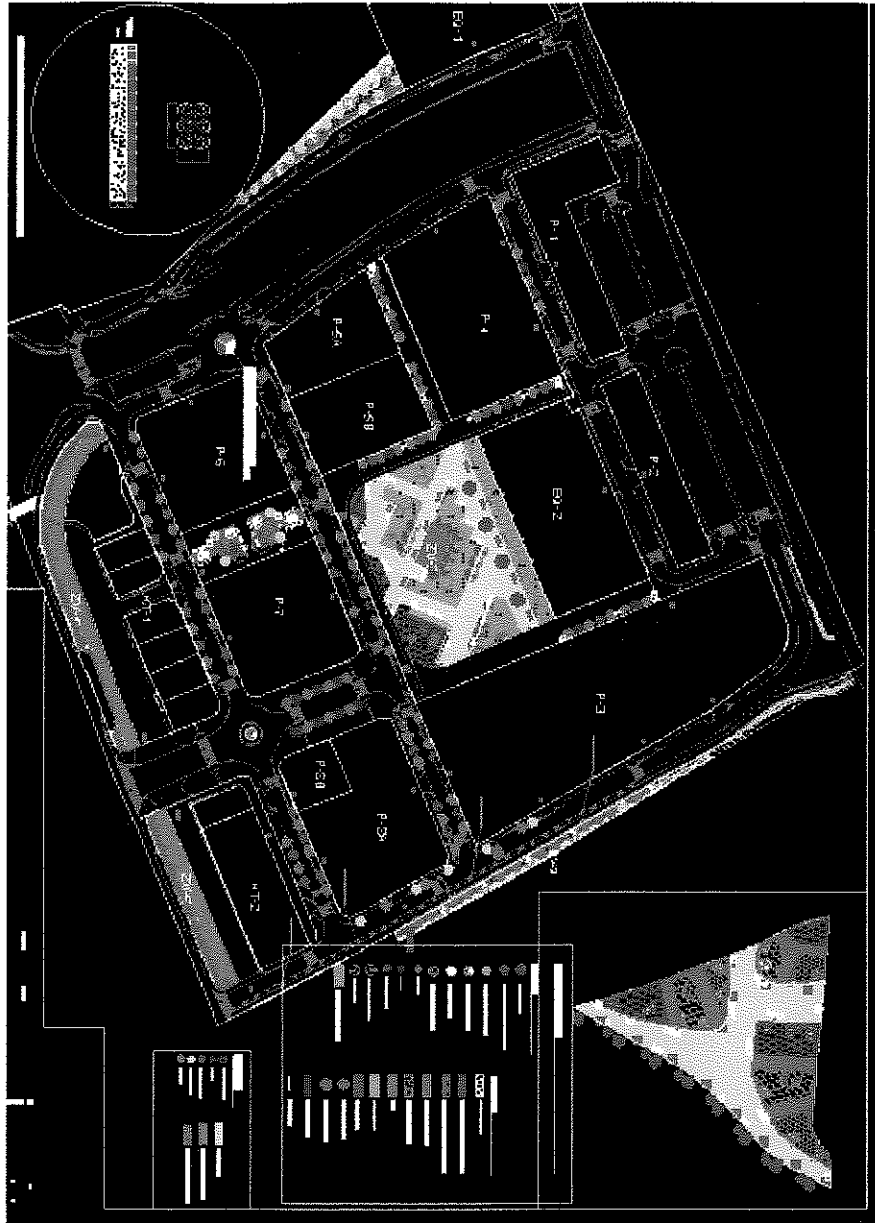

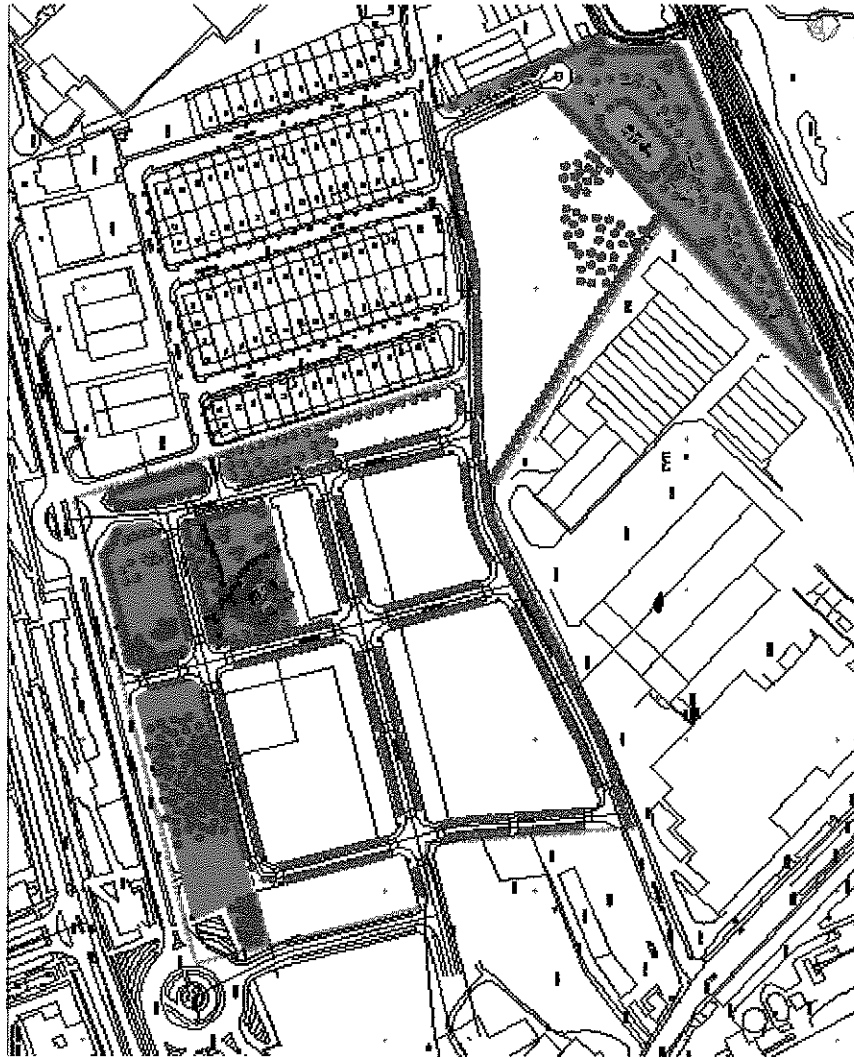



URBANIZACION EL OLIVAR

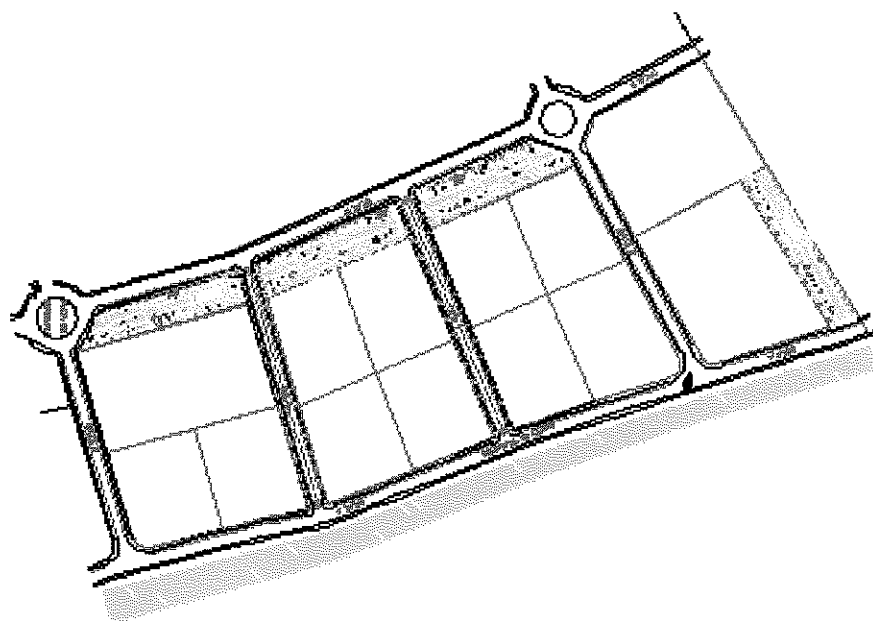



URBANIZACION EL OLIVAR

